



Ersatzteilliste für Motorhandstück Art.-Nr. 9300
List of spare parts for motorhandpiece art.-no. 9300



4125 Stift / pin



6642 Ø2,35mm Spannzange / chuck
(6643 Ø3,00mm) Spannzange / chuck

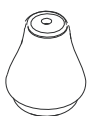

6653/1 Spitze / tip



6652 Dichtkappe 2,35mm / sealing cap
(6652/1 Dichtkappe 3,00mm/ sealing cap)

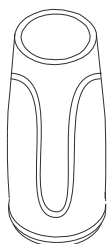

6662/2 Griffhülse / gripsleeve

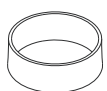

9309 Übergangsring / ring

Werkzeuge für Spannzangenwechsel
Tools to change chuck

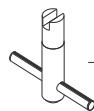

6223 Gegenschlüssel
counter stay wrench

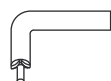

4115 Spannzangenschlüssel
chuck key

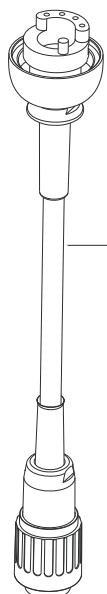

9225 Motorkabel / motor cable



SCHICK
DENTAL

Schick GmbH
Lehenkreuzweg 12
D-88433 Schemmerhofen
Telefon +49 7356 9500-0
Telefax +49 7356 9500-95
E-Mail info@schick-dental.de
Internet www.schick-dental.de